

Parts Breakdown—Eagle Series Standard and High Output Models

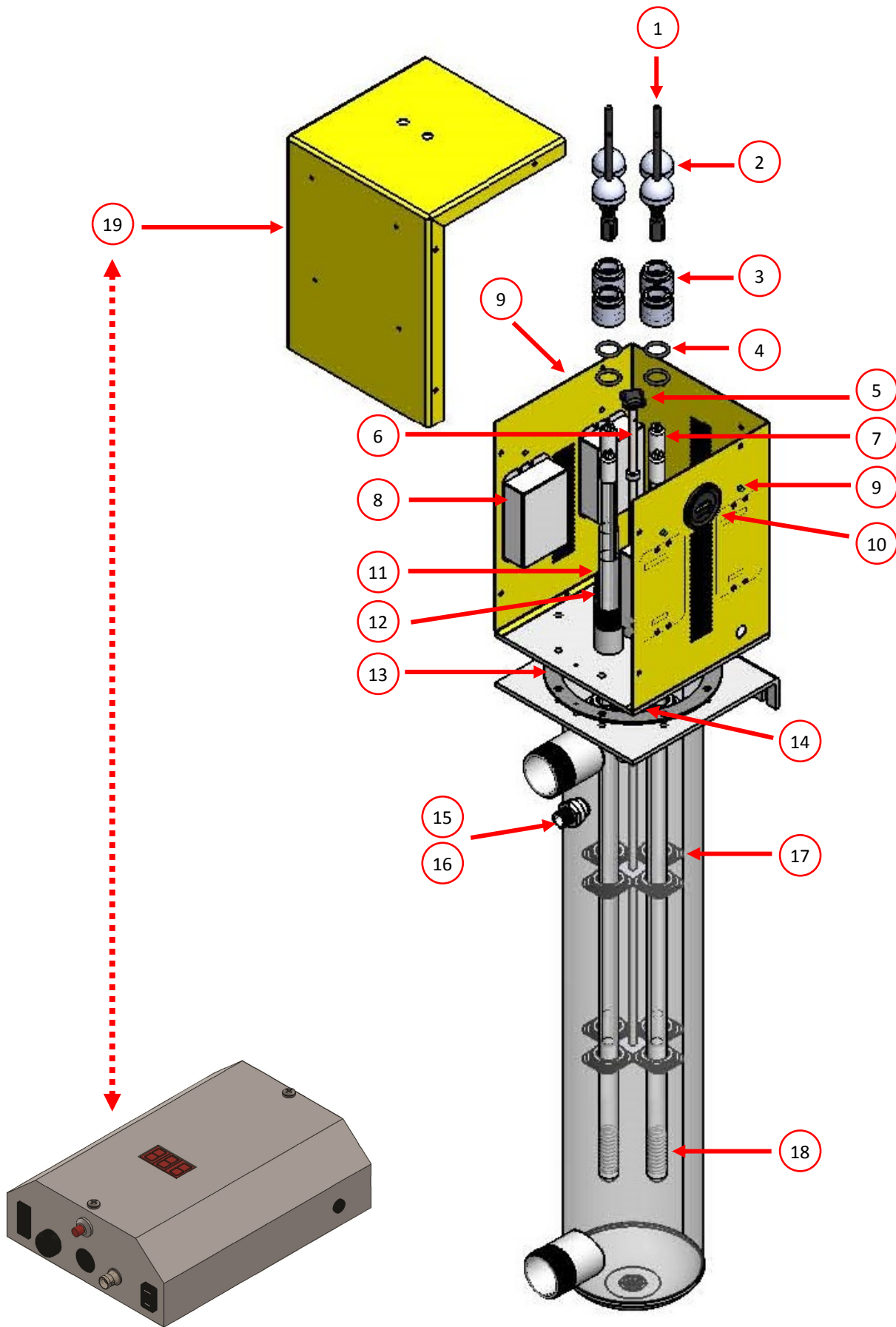

Replacement Parts List

Item No.	Description	Part No.	Quantity Required					
			EG1-HO	EG2-HO	EG3-S	EG3-HO	EG4-S	EG4-HO
1	Lamp Harness	LH0006	1	2	3	3	4	4
2	Compression Cap	CN0002	1	2	3	3	4	4
3	Compression Nut	CN0001	1	2	3	3	4	4
4	Sleeve O-Ring, EPDM	ORNG0009	1	2	3	3	4	4
5	Quartz Wiper Knob	KNOB0002	1	1	1	1	1	1
6	Wiper Extension Rod	WER0001	1	1	1	1	1	1
7	Standard Output Lamp—254NM	GL-5843-4S74R	X	X	3	X	4	X
	High Output Lamp—254NM	GL-5843-4H	1	2	X	3	X	4
8	Ballast—Standard Output Lamps	BLST0033	X	X	3	X	4	X
	Ballast—High Output Lamps	BLST0034	1	2	X	3	X	4
9	Lamp Status Indicator	LED0100-4	1	2	3	3	4	4
10	Elapsed Runtime Meter	ERTM0100	1	1	1	1	1	1
11	Quartz Sleeve, Domed	G36-2450	1	2	3	3	4	4
12	Wiper Seal Nut Assembly	WSNA001	1	1	1	1	1	1
13	Head Gasket	GSKT0001	1	1	1	1	1	1
14	Thermistor (Optional)	THERM0100	1	1	1	1	1	1
15	UV View Port	VPM0001	1	1	1	1	1	1
16	UV Sensor (Optional)	4-0008	1	1	1	1	1	1
17	Wiper Ring	2-0048	3	6	9	9	12	12
18	Quartz Spring	SPRING0001	1	2	3	3	4	4
19	UV Monitor (Optional)	UV-MON-IH	1	1	1	1	1	1